

# CHAPERONE SCHEDULE FOR WASHINGTON STATE HISTORY MUSEUM FIELD TRIP

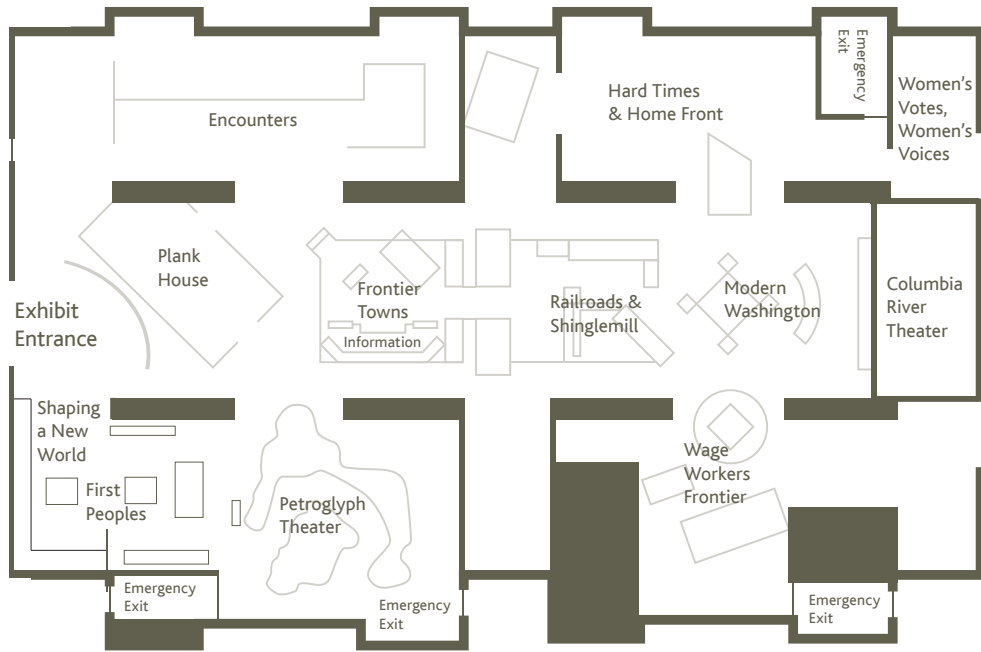

## HISTORY LAB

Great Hall of Washington History 3rd floor



*The map to the left is of the Great Hall of Washington History, located on the 3rd floor.*

**Floor 1:**  
Parking Exit

**Floor 2:**  
Education Entrance  
Lunchrooms  
Restrooms

**Floor 3:**  
Admissions  
Great Hall of Washington History

**Floor 4:**  
Mezzanine - No Exhibits

**Floor 5:**  
Changing Exhibits  
History Lab  
Restrooms

### YOUR SCHEDULE

Meet at School at: \_\_\_\_\_ in \_\_\_\_\_

Museum Arrival: \_\_\_\_\_ 2nd floor Education Entrance

Lunchtime: \_\_\_\_\_ in \_\_\_\_\_

History Lab Visit Time: \_\_\_\_\_ Museum Store Visit Time: \_\_\_\_\_

Departure Time: \_\_\_\_\_ 2nd floor Education Entrance

### YOUR STUDENT GROUP

\_\_\_\_\_

\_\_\_\_\_

\_\_\_\_\_

\_\_\_\_\_

\_\_\_\_\_

\_\_\_\_\_

## MUSEUM EXPECTATIONS

*Please ask students to...*

- Stay with you at all times.
- Keep all bags and backpacks out of the galleries.
- Turn the flash off on their cameras.
- Use quiet voices when indoors.
- Keep all food and drink in the lunchroom.

Like all museums, the history museum does have certain artifacts that are alarmed. Please ask students to avoid leaning over the railings to avoid setting off the alarms.